

STEEL DOOR LATERALS

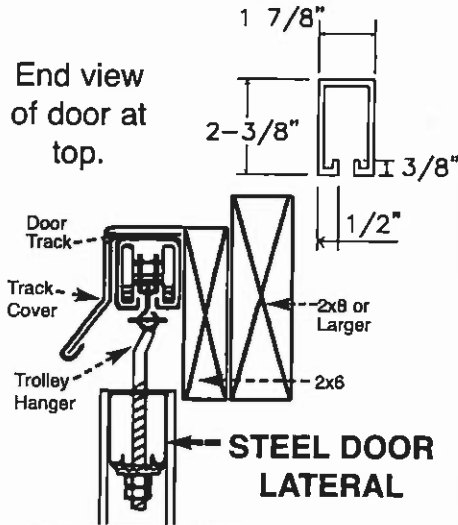

Door Height	Laterals Required	Spacing of laterals
7'	4	27"
8'	4	32"
9'	4	36"
10'	5	30"
11'	5	32"
12'	5	36"
13'	6	30"
14'	6	34"
15'	6	36"
16'	7	32"

SIZE	SKU#	SIZE	SKU#
4'	155-4513	12'	155-4678
5'	155-4539	13'	155-4694
6'	155-4555	13' 6"	155-4704
7'	155-4571	14'	155-4717
8'	155-4597	15'	155-4733
9'	155-4610	16'	155-4759
10'	155-4636	18'	155-4775
11'	155-4652	20'	155-4791

STEEL DOOR VERTICALS

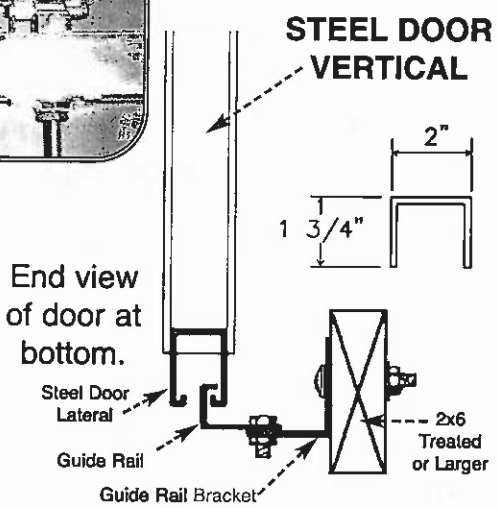
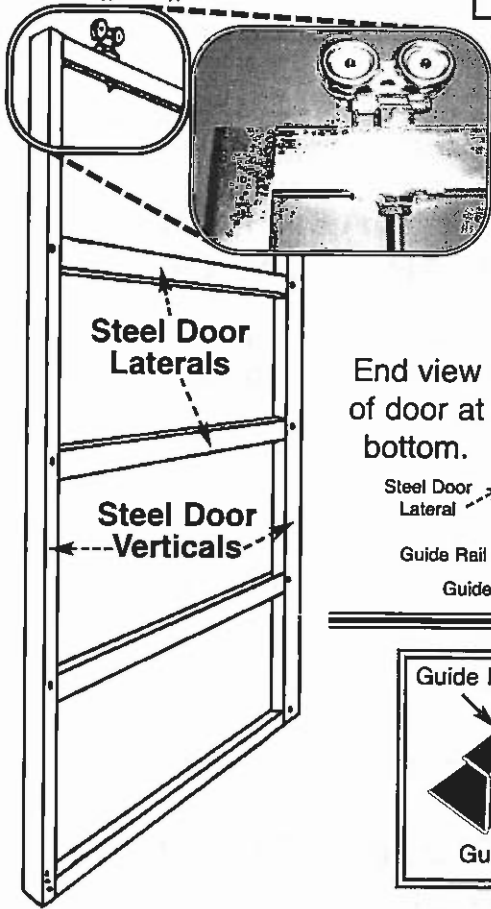

- Fast, simple strong assembly
- Tabloc design
- Galvanized for long life

SIZE	SKU#	SIZE	SKU#
7'	155-4843	12'	155-4898
8'	155-4856	13'	155-4908
9'	155-4869	14'	155-4911
10'	155-4872	15'	155-4924
11'	155-4885	16'	155-4937

GUIDE RAIL & BRACKET

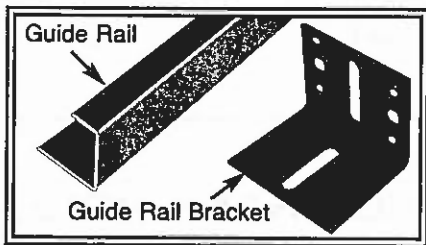

- Guide Rail Brackets included with every guide rail.

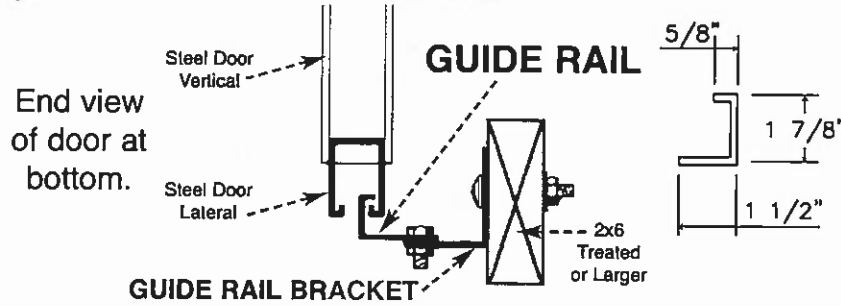

SIZE	Door Widths	No. of Brackets Included	SKU#
3'	Up to 6'	2	155-4995
6'	Up to 12'	3	155-5020
8'	Up to 16'	3	155-5046
10'	Up to 20'	4	155-5062

15. Sliding Door Framing

A. Kwik Frame

1. 2x4 Door Jambs
-Outside face of the pole.
2. Door Headers
-2x12 on sidewalls in door opening.
3. Track Board Support
-2x12 on sidewall outside of the door opening.
4. 2x6 Sliding Door Center Track Board
a. Same length as the door opening.
b. Top of 2x6 mounted 5-1/2" above door height.
5. 2x4 Sliding Door Track Board
a. Sidewalls extends to the width of the door.
b. Endwalls extends the entire width of the endwall.
c. Top of 2x4 mounted 5-1/2" above door height.
6. 2x6 Treated Door Runner
-Bottom grade board of the door.
7. 2x4 Treated Sliding Door Runner
-Mounted at the bottom of the wall on the side to which the door opens.
8. 2x4 Sliding Door Girts
-Door girts having the same spacing as the sidewall girts.
9. 2x6 Sliding Door Top Girt
-Placed at the top of the sliding door used to attach the trolley hangers to.

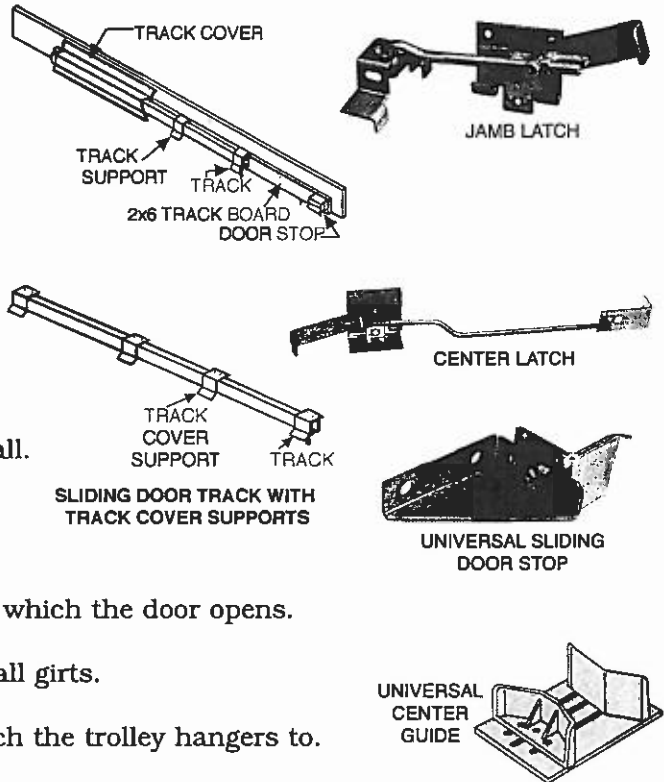

10. Kwik Frame Hardware

- a. Sliding Door Track
-See Chart Page 13.
- b. Sliding Door Track Cover
1. Sidewalls, twice the door width.
2. Endwalls, width of the building.
- c. Track Cover Support Brackets
-One bracket for every 4' of unsupported cover.
- d. Trolley Hangers
1. One pair of trolleys per door.
2. Inset equals 1/4 the door width.
- e. Jamb Latch
-One for each side of the door.
- f. Center Latch
-For split sliders only.
- g. Door Jamb Trim
1. Same length as door height.
2. One on each door post.
- h. Kwik Frame Verticals
1. 2 for a single slider.
2. 3 for a split slider.
- i. Double Couple
-For split sliders only.
- j. Stay Roller
-One per door.
- k. Universal Sliding Door Stop
-One per door.
- l. Universal Center Guide
-For split doors only.

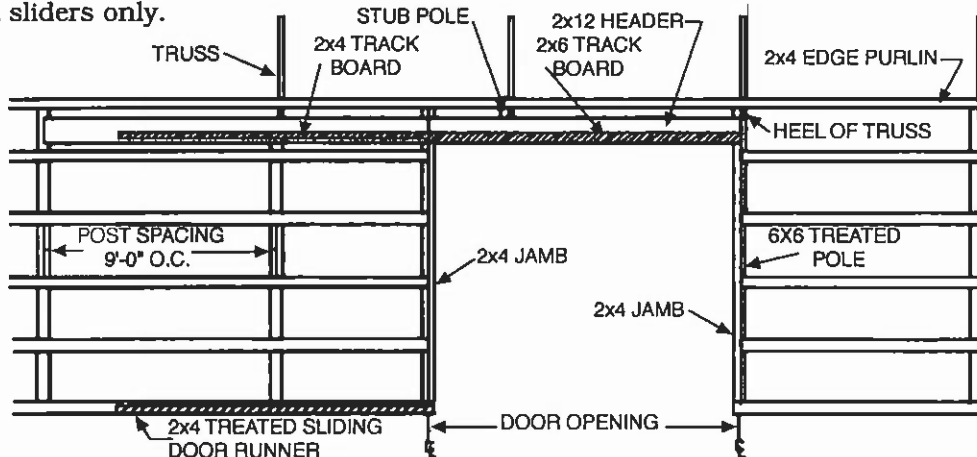
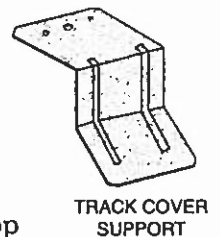

SIDEWALL SLIDING DOOR FRAMING DETAIL

B. Tab-Loc Door

1. 2x4 Door Jambs
-Outside face of the pole.
2. Door Headers
-2x12 on sidewalls in door opening.
3. Track Board Supports
-2x12 on sidewall outside of the door opening.
4. 2x6 Sliding Door Center Track Board
 - a. Same length as the door opening.
 - b. Top of 2x6 mounted 5-1/2" above door height.
5. 2x4 Sliding Door Track Board
 - a. Sidewalls extends to the width of the door.
 - b. Endwalls extends the entire width of the endwall.
 - c. Top of 2x4 mounted 5-1/2" above door height.
6. **Tab-Loc** Door Hardware
 - a. Sliding Door Track
-See Chart Below.
 - b. Sliding Door Track Cover
 1. Sidewalls, twice the door width.
 2. Endwalls, width of the building.
 - c. Track Cover Support Brackets
-One bracket for every 4' of unsupported cover.
 - d. Trolley Hangers
 1. One pair of trolleys per door.
 2. Inset equals 1/4 the door width.
 - e. Jamb Latch
-One for each side of the door.
 - f. Center Latch
-For split sliders only.

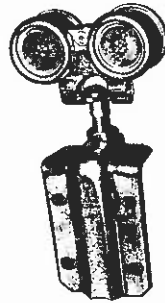

TROLLEY HANGER

- g. Door Jamb Trim
 1. Same length as door height.
 2. One on each door post.
- h. Steel Door Verticals
 1. 2 for a single slider.
 2. 4 for a split slider.
- i. Steel Door Laterals
-See chart in MM Book.
- j. Guide Rail w/Brackets
-See chart in MM Book.
- k. Single Door Stop
-One per door.
- l. Jamb Mount Door Stop
-One per door single slider (2 on split slider).
- m. Heavy Duty Door Handle
-One per door.
- n. Vertical Door Trim
 1. 2 for a single slider.
 2. 3 for a split slider.
- o. Astragal Door Trim
-For split sliders only.

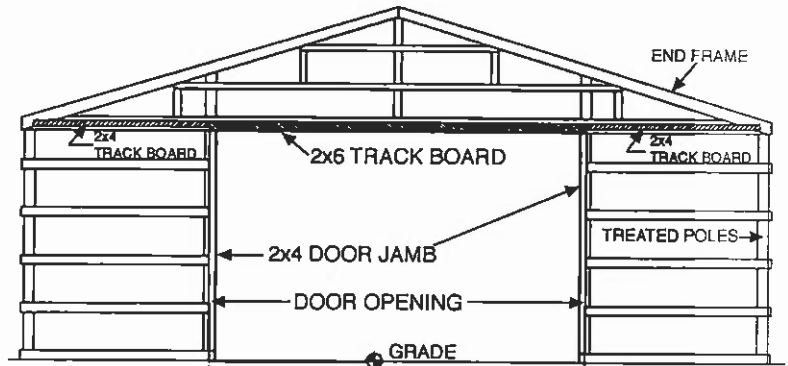

ENDWALL SLIDING DOOR FRAMING DETAIL

Door Width	Track Size	Trolley Backset
4'	6'	1'-0"
5'	8'	1'-3"
6'	10'	1'-6"
7'	12'	1'-9"
8'	12'	2'-0"
9'	14'	2'-3"
10'	16'	2'-6"
11'	8' + 10'	2'-9"
12'	8' + 10'	3'-0"
13'	10' + 10'	3'-3"
14'	10' + 12'	3'-6"
15'	12' + 12'	3'-9"
16'	12' + 12'	4'-0"
17'	12' + 14'	4'-3"
18'	14' + 14'	4'-6"
19'	14' + 16'	4'-9"
20'	16' + 16'	5'-0"

